

Steamfast™

MODEL

SF-210



EVERYDAY STEAM CLEANER

OWNER'S GUIDE

IMPORTANT SAFETY INSTRUCTIONS

This owner's guide and any additional inserts are considered part of the product. They contain important information about safety, use, and disposal. Before using the product, please familiarize yourself with all operating and safety instructions. Please keep all documents for future reference and pass these documents on, together with the product, to any future owner. See our website for the most current version of this owner's guide.

INTENDED USE: This product is intended to be used indoors for household cleaning in the United States and/or Canada. This product is not intended for commercial or industrial uses. The manufacturer assumes no responsibility for damage or injury due to unauthorized use or product modification. Failure to follow these directions will void the product warranty.

WARNING: Risk to Children and Impaired Persons.

Supervision is required during the installation, operation, cleaning and maintenance of this product by children under age 12 and anyone with reduced physical, sensory or mental capabilities.

Children should be supervised to ensure that they do not play with the appliance, its parts and packaging material.

Directions to reduce risk of fire, electrical shock, and injury:

1. Read all instructions before use.
2. If an extension cord is necessary, use a properly rated cord (15 ampere, 14 gauge). Use care to position extension cord where it is least likely to be damaged or tripped over during use.
3. Before plugging power cord into electrical outlet, be sure that all electrical information on rating label agrees with your power supply.
4. To reduce likelihood of circuit overload, DO NOT operate another high wattage appliance on the same circuit as this unit.
5. To reduce the risk of electric shock, do not immerse the appliance in water or other liquids. If product falls into water or another liquid, immediately unplug. Do not reach into the water while product is plugged in.
6. Do not use power cord as handle, let it hang over edges of counters or be crimped or closed in doors.
7. Never yank power cord to disconnect from outlet; instead, grasp plug and pull to disconnect.
8. Do not operate unit with a damaged power cord or if the unit has been dropped or damaged. To avoid risk of electrical shock, do not disassemble unit; contact Steamfast Consumer Service for examination and repair. Incorrect reassembly can cause a risk of electrical shock when unit is used.
9. A loose fit between wall outlet (receptacle) and plug may cause overheating and distortion of the plug. Discontinue use of the product in this outlet. Contact a qualified electrician to replace loose or worn outlets.
10. Do not leave unit unattended while plugged in. Do not leave appliance unattended while connected. Unplug the appliance immediately after each use.
11. Do not use unit where aerosol-based products are being used, or where oxygen is being administered.
12. Unit is only meant to be used with recommended Everyday Steam Cleaner (model SF-210) accessories. Using other types of attachments may cause damage to unit or injury.
13. Always unplug power cord before filling with water. Do not attempt to use unit without properly filling.
14. When filling, only water should be used in unit – other cleaning agents could damage unit or cause injury. Distilled or de-mineralized water is highly recommended, in order to minimize potential build-up of mineral deposits.

-
15. To avoid burns from escaping steam when removing cap to refill unit:
 - Always allow unit to cool for 5-10 minutes.
 - Press and hold Steam Button to release all remaining steam pressure.
 16. To reduce risk of contact with hot water emitting from Main Nozzle, check appliance before each use by positioning it away from body and turning it on. Do not operate unit if Main Nozzle is blocked.
 17. Burns can occur from touching hot metal parts, hot water, or steam. Do not touch Main Nozzle or attempt to connect accessories while unit is in use. Use caution when you turn unit upside-down – there may be hot water.
 18. Use caution when using unit on uneven surfaces, such as stairs. Do not place, set or store the product near water, such as a bathtub or sink. Never immerse the product in liquids. Do not allow cord to touch hot surfaces.
 19. When steaming any surface for the first time, it is recommended that you consult the manufacturer's guidelines for material being steamed. For items in question, test on an inconspicuous area before proceeding.
 20. Steaming unsealed hardwood or unglazed ceramic surfaces is not recommended, and may result in warping or damage to the surface. Steam may remove the sheen from surfaces treated with wax.
 21. Do not allow power cord to touch hot surfaces during use. Bundle cord loosely when storing.
 22. Always allow Everyday Steam Cleaner to cool (at least 30 minutes for complete cooling) and empty unit before storing. Do not store unit with a damp Microfiber Pad still attached.

WARNING: Changes or modifications to this unit not expressly approved by the party responsible for compliance could void the user's authority to operate the equipment.

SAVE THESE INSTRUCTIONS

The following features and accessories are included with your Everyday Steam Cleaner. Carefully inspect the packing material for all parts listed below. To obtain possible missing parts, refer to **Product Support** on Page 14 of this manual for Consumer Service contact information.

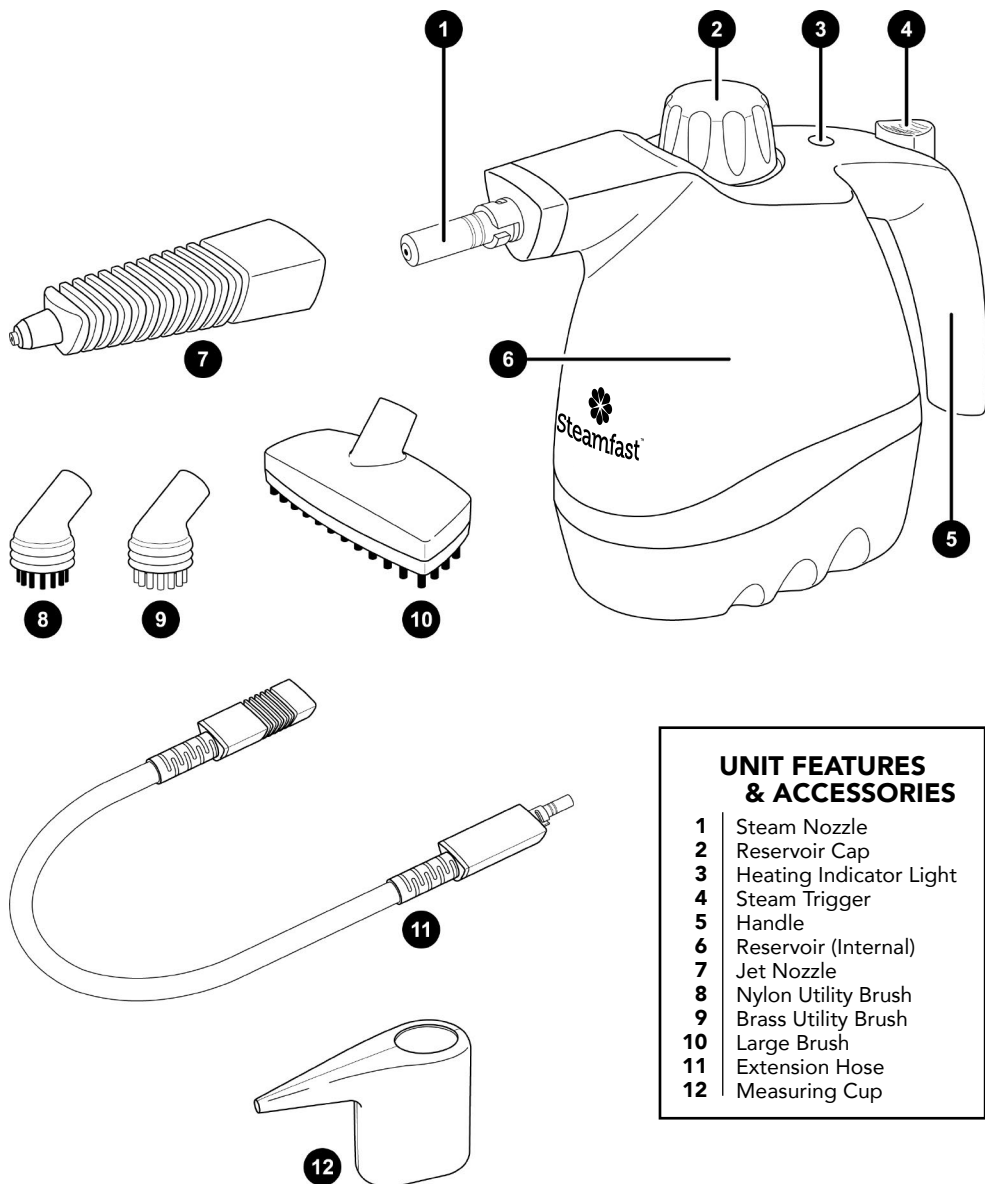

UNIT FEATURES & ACCESSORIES

- 1 Steam Nozzle
- 2 Reservoir Cap
- 3 Heating Indicator Light
- 4 Steam Trigger
- 5 Handle
- 6 Reservoir (Internal)
- 7 Jet Nozzle
- 8 Nylon Utility Brush
- 9 Brass Utility Brush
- 10 Large Brush
- 11 Extension Hose
- 12 Measuring Cup

-
- The *Steam Nozzle* (1) emits a flow of hot, penetrating steam whenever the *Steam Trigger* is pressed and held. The *Jet Nozzle* or *Extension Hose* should always be connected to the *Steam Nozzle* when the unit is in use.
 - The *Reservoir Cap* (2) is designed to safely contain steam inside the *Reservoir*. The *Reservoir Cap* must be unscrewed and removed in order to fill the *Reservoir* with water.
 - The *Heating Indicator Light* (3) illuminates when the power cord is plugged in and the *Reservoir* has begun heating. The *Heating Indicator Light* will turn off when the *Reservoir* is fully heated and the unit is ready to begin producing steam.
 - The *Steam Trigger* (4) is pressed and held in order to start the flow of steam from the *Steam Nozzle*, then released when you wish to stop.
 - The *Handle* (5) is engineered to stay cool while providing maximum grip and comfort.
 - The *Reservoir* (6) is the internal reservoir where water is held and heated into steam. For optimal steam production, the *Reservoir* should be filled with no more than 6 oz (180 ml) of water.
 - The *Jet Nozzle* (7) connects to the *Steam Nozzle* and is designed to focus the flow of steam for concentrated cleaning. The *Nylon Utility Brush*, *Brass Utility Brush* and *Large Brush* all connect to the *Jet Nozzle*. Alternatively, the *Jet Nozzle* may be connected to the end of the *Extension Hose*.
 - The *Nylon Utility Brush* (8) connects to the *Jet Nozzle* and is designed for scrubbing especially tough stains. The *Nylon Utility Brush* is ideal for use on many surfaces around the home, including carpet, ceramic tile, grouting, and more.
 - The *Brass Utility Brush* (9) connects to the *Jet Nozzle* and is designed for scrubbing especially tough stains. The *Brass Utility Brush* is perfect for use on BBQ grills, oven racks, automobile engines, shop tools and other hard metal surfaces.
 - The *Large Brush* (10) connects to the *Jet Nozzle* and is designed for scrubbing especially tough stains. The *Large Brush* functions similar to the *Nylon Utility Brush*, only designed to more efficiently scrub larger surface areas.

NOTE: Some delicate surfaces, such as painted wood or stainless steel, may be scratched or damaged by the bristles of the *Brushes* – especially the *Brass Utility Brush*. Use careful judgement when deciding what surface to clean with any of the *Brushes*. If you are unsure if a surface will be damaged, it is recommended that you test a small inconspicuous spot before proceeding.

- The *Extension Hose* (11) connects to the *Steam Nozzle* and is designed to provide additional freedom to easily reach a variety of spaces. The *Jet Nozzle* should be connected to the male end of the *Extension Hose* in order to safely focus the flow of steam.
- The *Measuring Cup* (12) provides an easy and convenient way to consistently fill the *Reservoir* with the optimum amount of water (6 oz / 180 ml).

CONNECTING JET NOZZLE

WARNING: DO NOT attempt to connect any accessories while unit is emitting steam. Doing so could result in burns or other injury.

1. Align Jet Nozzle with Steam Nozzle as shown (FIGURE 1-A). Jet Nozzle should be sideways 90° counter-clockwise from it's final position. Guide keys on Jet Nozzle should line up with key slots on base of Steam Nozzle (FIGURE 1-B).

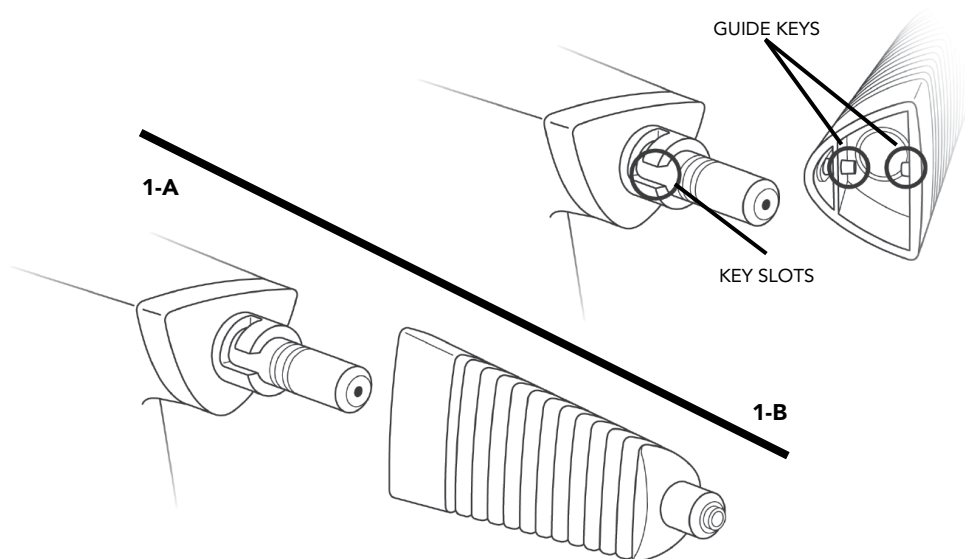

FIGURE 1

2. Slide Jet Nozzle onto Steam Nozzle - guide keys should fit into key slots. Push Jet Nozzle on as far as it will go (FIGURE 2-A). Rotate Jet Nozzle 90° clockwise, turning it until it will move no further (FIGURE 2-B).

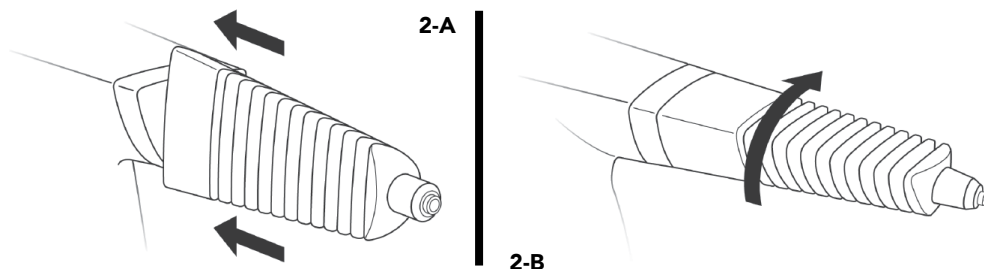

FIGURE 2

CONNECTING BRUSHES

NOTE: The Nylon Utility Brush, Brass Utility Brush and Large Brush are all attached in the same manner. The Nylon Utility Brush is illustrated in FIGURE 3 as an example.

1. Align Brush with Jet Nozzle as shown. Guide key on back of Brush should line up with key slot on side of Jet Nozzle tip (FIGURE 3-A).
2. Firmly press Brush onto Jet Nozzle (FIGURE 3-B).

CAUTION: Make sure Brush is pushed as far as possible onto tip to ensure that it is seated securely. This will prevent steam leaks and ensure that Brush is not forced off of Jet Nozzle by steam pressure.

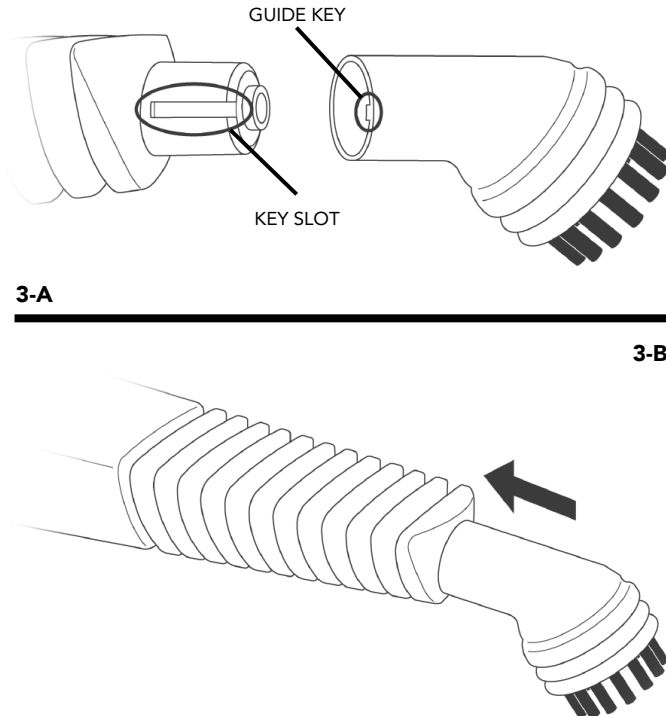

FIGURE 3

CONNECTING EXTENSION HOSE

1. Align female end of Extension Hose with Steam Nozzle (FIGURE 4-A). Guide keys on Extension Hose should line up with key slots on base of Steam Nozzle (FIGURE 4-B).
2. Slide Extension Hose onto Steam Nozzle, being sure to push it on as far as it will go. Rotate Extension Hose clockwise, turning it until you feel it "lock" into place and it will move no further.

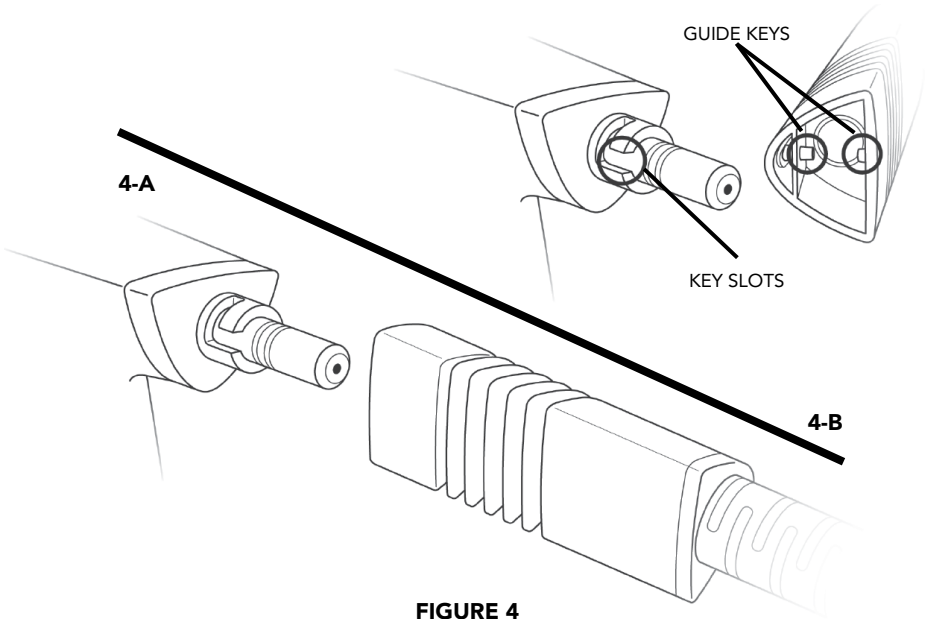

FIGURE 4

3. Align Jet Nozzle with male end of Extension Hose. Guide keys on Jet Nozzle should line up with key slots on base of Extension Hose nozzle.
4. Slide Jet Nozzle onto Extension Hose, being sure to push it on as far as it will go (FIGURE 5-A). Rotate Jet Nozzle clockwise, turning it until you feel it "lock" into place and it will move no further (FIGURE 5-B).

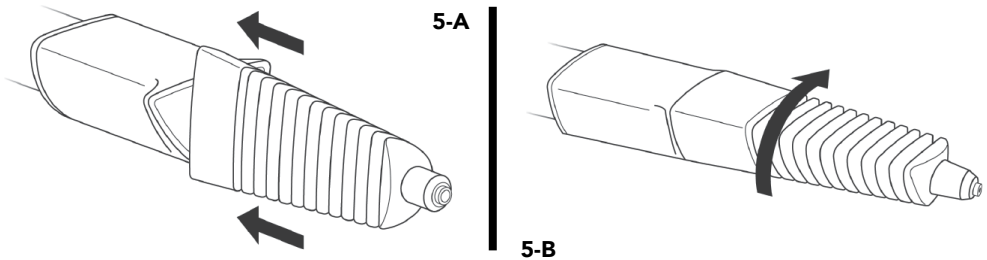

FIGURE 5

FILLING RESERVOIR

1. Place Everyday Steam Cleaner on a flat, level surface.
2. Make sure power cord is unplugged from electrical outlet.
3. Cautiously remove Reservoir Cap by unscrewing it in a counter-clockwise direction and lift it off.

CAUTION: Refer to refilling procedure below for additional safety precautions that must be taken when refilling the unit after it has been in use.

4. Reservoir should always be emptied after each use. If it was not emptied after the previous use, empty it now – this will make it easier to fill with the correct amount of water.
5. Fill included Measuring Cup with 6 oz (180 ml) of water.

NOTE: In order to extend the life of your Everyday Steam Cleaner and keep it functioning at it's maximum potential, it is highly recommended that distilled or de-mineralized water be used in Reservoir.

6. Carefully pour water from Measuring Cup into Reservoir through fill hole.

NOTE: Do not exceed the Reservoir's maximum capacity of 6 oz (180 ml). This will ensure a better flow of steam with minimal dripping water.

7. Replace Reservoir Cap, screwing it in a clockwise direction to tighten. Make sure it is screwed on securely to prevent hot water or steam from escaping.

REFILLING RESERVOIR



If unit has been in use, always use the following safety precautions before removing the Reservoir Cap to add water:

- Allow unit to cool for 5-10 minutes.
- Press and hold Steam Trigger to release all remaining steam. **Steam can remain pressurized inside Reservoir for up to an hour after use.**

WARNING: Failure to follow these precautions may result in burns from escaping steam when the Reservoir Cap is removed.

STEAM CLEANING

NOTE: Before operating, make sure all desired accessories are connected and Reservoir is filled with the correct amount of water (refer to Pages 6-9 for details).

1. For first-time use, remove protective plastic cover that is shipped on electrical plug. Plug power cord into a convenient 3-prong electrical outlet. Heating Indicator Light will illuminate to show that unit is receiving power and Reservoir has begun to heat.

CAUTION: This unit uses a grounded (3-prong) electrical plug. Use only in properly installed 3-prong electrical outlets. Do not attempt to alter plug or circumvent this safety feature in any way.

2. After approximately 3 minutes, Heating Indicator Light will turn off. This indicates that Reservoir is fully heated, and unit is ready to begin steaming.

NOTE: Heating Indicator Light may cycle off and on during use, accompanied by a slight temporary drop in steam pressure – this is a normal part of operation, as the Reservoir works to maintain a steady optimal temperature.

3. Point Jet Nozzle (and any connected accessories) towards surface you wish to steam, and press Steam Trigger. Hold Trigger down for a continuous flow of steam.

CAUTION: Always be sure that Jet Nozzle and other accessories are pointed in a safe direction (away from yourself, other people, pets, and plants) before pressing Steam Trigger.

NOTE: When steaming any surface for the first time, it is recommended that you consult the manufacturer's guidelines for material being steamed. For items in question, test steam on an inconspicuous area before proceeding.

4. Using a slight back-and-forth motion over the area you are steaming will enhance the cleaning process, as will scrubbing the area (if a Brush is connected). Wipe steamed areas with a clean cloth to remove loosened dirt and grime.

CAUTION: Wiping an area while it is still wet is recommended, but use care when wiping surfaces such as metal that may still be hot.

5. Hold Jet Nozzle (and any connected accessories) approximately 1/2 inch from surface and press Steam Trigger. Keep Trigger held and concentrate steam on the same spot for at least 5 seconds.
6. At its maximum capacity (6 oz / 180 ml), the Reservoir will provide approximately 8 minutes of continuous steam. If you wish to continue steaming, refer to **Filling Reservoir** procedure on Page 9 – be sure to note **Refilling Reservoir** section at bottom of page 9.
7. Once you are finished using your Everyday Steam Cleaner, immediately unplug power cord from electrical outlet. Refer to **Storage & Care** guidelines on Page 11 for proper cleaning and storage procedures.

PROPER STORAGE

Preparing your Everyday Steam Cleaner for storage is quick and simple. When you have finished your steaming tasks, follow the steps listed below.

1. Unplug power cord from electrical outlet.
2. Allow unit to cool (30 minutes for complete cooling).
3. Press and hold Steam Trigger to release all remaining steam pressure.
4. Unscrew and remove Reservoir Cap. Drain all remaining water from Reservoir into a sink or tub, then loosely replace Reservoir Cap.

NOTE: Do not overtighten Reservoir Cap when storing, as this may make it difficult to remove during next use.

5. Loosely bundle power cord, and store Everyday Steam Cleaner in a cool dry location.

CARE & MAINTENANCE

A common maintenance need for steam appliances is the removal of build-up caused by high mineral content in many municipal water supplies. This mineral build-up may limit the effectiveness and reduce the life of your Everyday Steam Cleaner.

The best way to minimize mineral build-up is to use distilled or de-mineralized water when using your Everyday Steam Cleaner. If you are unable to use distilled water, it is recommended that the following procedure be followed monthly to help remove any mineral build-up:

To remove mineral build-up:

1. Unplug power cord from electrical outlet.
2. Allow unit to cool (30 minutes for complete cooling).
3. Press and hold Steam Trigger to release all remaining steam pressure.
4. Unscrew and remove Reservoir Cap, and drain any remaining water from Reservoir into a sink or tub.
5. Fill Measuring Cup with 6 oz (180 ml) distilled vinegar. Carefully pour vinegar into Reservoir.
6. Slowly shake or move unit around to agitate vinegar.
7. Allow to stand for at least 40 minutes, or more if possible.
8. Drain vinegar from Reservoir.
9. Rinse Reservoir with fresh water, drain and repeat until vinegar odor dissipates.
10. Loosely replace Reservoir Cap and continue with normal storage procedure, as outlined in **Proper Storage** section above.

PROBLEM	POSSIBLE CAUSE	SOLUTION
Unit fails to heat up. Heating Indicator Light DOES NOT illuminate.	Unit is not plugged in.	Plug power cord into electrical outlet.
	Household circuit breaker / ground fault interrupter has tripped or blown a fuse.	Reset circuit breaker / ground fault interrupter, or replace fuse. For assistance, contact a licensed electrician.
	Unit is damaged or otherwise in need of repair.	Immediately cease usage and unplug. Contact Consumer Service for assistance (see below for details).
Unit fails to heat up. Heating Indicator Light DOES illuminate. NOTE: Always allow sufficient time for unit to heat up before pressing Steam Trigger.	No water in Reservoir.	Refer to Filling Reservoir procedure on Page 9 to fill unit with water.
	Mineral build-up in unit.	Refer to Care & Maintenance section on Page 11 for details.
	Unit is damaged or otherwise in need of repair.	Immediately cease usage and unplug. Contact Consumer Service for assistance (see Page 13 for details).
Steam output is weak or intermittent.	Water level in Reservoir is running low.	Refer to Refilling Reservoir procedure on Page 9 to refill unit with water.
	Mineral build-up in unit.	Refer to Care & Maintenance section on Page 11 for details.
Reservoir Cap cannot be unscrewed.	Reservoir Cap has been overtightened after previous use.	Reservoir Cap should always be replaced <u>loosely</u> when storing. For assistance with a Cap that has become stuck, contact Consumer Service (see Page 13 for details).

ACCESSORIES & PARTS

When ordering accessories and parts for your Everyday Steam Cleaner, you may refer to the part numbers below. Accessories and parts may be ordered through our Web site:

www.steamfast.com

You may also contact Consumer Service directly:

consumerservice@steamfast.com or 1-800-711-6617

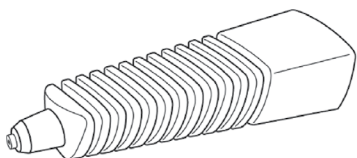

JET NOZZLE
A210-100R-

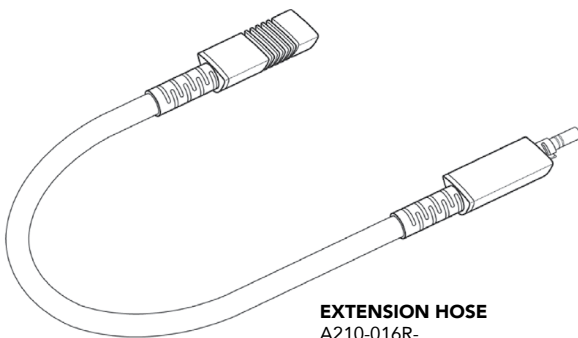

EXTENSION HOSE
A210-016R-

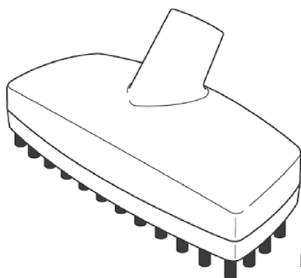

LARGE BRUSH
A210-001R-

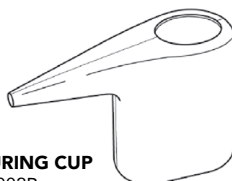

MEASURING CUP
A142-P002R-



NYLON UTILITY BRUSH
A210-003R-

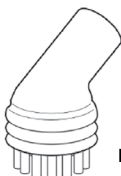

BRASS UTILITY BRUSH
A210-004R-

NOTE: Due to continuing improvements, part numbers listed above may change. For assistance ordering parts, please contact Consumer Service directly.

Steamfast, a division of Vornado Air, LLC. Steamfast warrants to the original consumer or purchaser this Steamfast ("Product") is free from defects in material or workmanship for a period of two (2) years from the date of purchase. If any such defect is discovered within the warranty period, Vornado, at its discretion, will repair or replace the Product at no cost.

For warranty service: Call 1-800-711-6617 or email consumerservice@steamfast.com to obtain a Return Authorization ("RA"). Please have or include your Product's model number and serial number, as well as your name, address, city, state, Zip code, email, and phone number when contacting Vornado for warranty service. To file a contactless warranty claim, visit www.steamfast.com/contact

After receiving the RA, ship your Product to: Vornado Air LLC Attn: Warranty & Repair 415 East 13th Street, Andover, KS 67002. For your convenience, please have your model number and serial number when contacting Vornado with service inquiries. To ensure proper handling, packages must be clearly marked with the RA number. Packages not clearly marked with the RA number may be refused at the receiving dock. Please allow 2–3 weeks for warranty service and return of your Product after the Product is received.

This warranty does not apply to defects resulting from abuse of the Product, modification, alteration, mishandling, improper maintenance, commercial use or repair or service of the Product by anyone other than Vornado; damages which occur in shipment or are attributed to acts of God. Improper product use, which includes using an external device that alters or converts the voltage or frequency of electricity, or shipping a Vornado product to a country not intended for use will void all warranties. Any unauthorized product modification, repair by unauthorized repair center or use of non-approved replacement parts is not recommended and any consequences will not be covered by support services or product warranties.

The product warranty will be honored only on models that are being used in the country intended. REPAIR OR REPLACEMENT AS PROVIDED UNDER THIS WARRANTY IS THE EXCLUSIVE REMEDY OF THE CONSUMER. VORNADO SHALL NOT BE LIABLE FOR ANY INCIDENTAL OR CONSEQUENTIAL DAMAGES FOR BREACH OF ANY EXPRESS OR IMPLIED WARRANTY ON THIS PRODUCT. EXCEPT TO THE EXTENT PROHIBITED BY APPLICABLE LAW, ANY IMPLIED WARRANTY OF MERCHANTABILITY OR FITNESS FOR A PARTICULAR PURPOSE ON THIS PRODUCT IS LIMITED IN DURATION TO THE DURATION OF THIS WARRANTY. Some states do not allow the exclusion or limitation of incidental or consequential damages, or allow limitations on how long an implied warranty lasts, so the above limitations or exclusions may not apply to you. This warranty gives you specific legal rights, and you may have other rights that vary from state to state. The manufacturer assumes no responsibility for damage or injury caused by failure to follow these instructions, improper product use or unauthorized product modifications. Any such actions will invalidate the product warranty.

All company names and product names are trademarks of their respective owners. ©All rights reserved. All technical information, data and instructions for the installation, connection and operation contained in these instructions for use correspond to the latest available information at time of printing. The contents of this manual may differ slightly from the actual product. Observe any additional supplements.

© 2023 Vornado Air, LLC. Andover, KS 67002, U.S. Specifications subject to change without notice. Steamfast® is a trademark owned by Vornado Air, LLC. Manufactured in China.

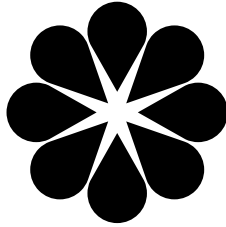

SteamfastTM

Steamfast

415 East 13th, Andover, KS 67002

1-800-711-6617 | steamfast.com | consumerservice@steamfast.com