

SteamfastTM

MODEL: SF-275



ENGLISH
P. 2

CANISTER STEAM CLEANER
OWNER'S GUIDE

IMPORTANT SAFETY INSTRUCTIONS

This owner's guide and any additional inserts are considered part of the product. They contain important information about safety, use, and disposal. Before using the product, please familiarize yourself with all operating and safety instructions. Please keep all documents for future reference and pass these documents on, together with the product, to any future owner. See our website for the most current version of this owner's guide.

INTENDED USE: This product is intended to be used indoors for household cleaning in the United States and/or Canada. This product is not intended for commercial or industrial uses. The manufacturer assumes no responsibility for damage or injury due to unauthorized use or product modification. Failure to follow these directions will void the product warranty.

WARNING: Risk to Children and Impaired Persons

Supervision is required during the installation, operation, cleaning and maintenance of this product by children age 12 and under and anyone with reduced physical, sensory or mental capabilities. Children should be supervised to ensure that they do not play with the appliance, its parts and packaging material.

Directions to reduce risk of fire, electrical shock, and injury:

1. Read all instructions before use.
2. If an extension cord is necessary, use a properly rated cord (15 ampere, 14 gauge). Use care to position extension cord where it is least likely to be damaged or tripped over during use.
3. Before plugging power cord into electrical outlet, be sure that all electrical information on rating label agrees with your power supply.
4. To reduce likelihood of circuit overload, DO NOT operate another high wattage appliance on the same circuit as this unit.
5. To reduce the risk of electric shock, do not immerse the appliance in water or other liquids. If product falls into water or another liquid, immediately unplug. Do not reach into the water while product is plugged in.
6. Do not use power cord as handle, let it hang over edges of counters, or be crimped or closed in doors.
7. Never yank power cord to disconnect from outlet; instead, grasp plug and pull to disconnect.
8. Do not operate unit with a damaged power cord or if the unit has been dropped or damaged. To avoid risk of electrical shock, do not disassemble unit; contact Steamfast Consumer Service for examination and repair. Incorrect reassembly can cause a risk of electrical shock when unit is used.
9. A loose fit between wall outlet (receptacle) and plug may cause overheating and distortion of the plug. Discontinue use of the product in this outlet. Contact a qualified electrician to replace loose or worn outlets.
10. Do not leave unit unattended while plugged in. Unplug the appliance immediately after each use.
11. Do not use unit where aerosol-based products are being used, or where oxygen is being administered.
12. Unit is only meant to be used with recommended accessories. Using other types of attachments may cause damage to unit or injury.
13. If Lighted On/Off Switch does not illuminate when set to "ON" position while power cord is plugged in, unit is not operating normally. Immediately disconnect cord from power supply, then refer to troubleshooting guide of this manual for assistance.
14. Always turn unit off and unplug power cord before filling with water. Do not attempt to use unit without properly filling.
15. When filling, only water should be used in unit – other cleaning agents could damage unit or cause injury. Distilled or de-mineralized water is highly recommended, in order to minimize potential build-up of mineral deposits. Do not overfill with more than recommended amount of water.
16. To avoid burns from escaping steam when removing cap to refill unit:

-
- Always allow unit to cool for 5-10 minutes.
 - Press and hold Steam Button to release all remaining steam pressure.
17. To reduce risk of contact with hot water emitting from Main Nozzle, check appliance before each use by positioning it away from body and turning it on. Do not operate unit if Main Nozzle is blocked.
 18. Burns can occur from touching hot metal parts, hot water, or steam. Do not touch Main Nozzle or attempt to connect accessories while unit is in use. Do not touch bottom of Mop Head or attempt to attach a Microfiber Pad by hand while unit is in use. Use caution when you turn unit upside-down – there may be hot water.
 19. Use caution when using unit on uneven surfaces, such as stairs. Do not place, set or store the product near water, such as a bathtub or sink. Never immerse the product in liquids. Do not allow cord to touch hot surfaces.
 20. When steaming any surface for the first time, it is recommended that you consult the manufacturer's guidelines for material being steamed. For items in question, test on an inconspicuous area before proceeding.
 21. Steaming unsealed hardwood or unglazed ceramic surfaces is not recommended, and may result in warping or damage to the surface. Steam may remove the sheen from surfaces treated with wax.
 22. When steam mopping, never leave unit resting in one spot on any surface for any period of time – prolonged exposure to heat and moisture may damage floor surfaces.
 23. Do not allow power cord to touch hot surfaces during use. Bundle cord loosely when storing.
 24. Always allow unit to cool (at least 30 minutes for complete cooling) and empty before storing. Do not store unit with a damp Microfiber Pad still attached.

WARNING: Changes or modifications to this unit not expressly approved by the party responsible for compliance could void the user's authority to operate the equipment.

SAVE THESE INSTRUCTIONS

Questions or comments?

- steamfast.com
- consumerservice@steamfast.com
- 1-800-711-6617

Speak your mind! We invite you to review this product online:
steamfast.com/reviews

The following features and accessories are included with your Canister Steam Cleaner. Carefully inspect the packing material for all parts listed below.

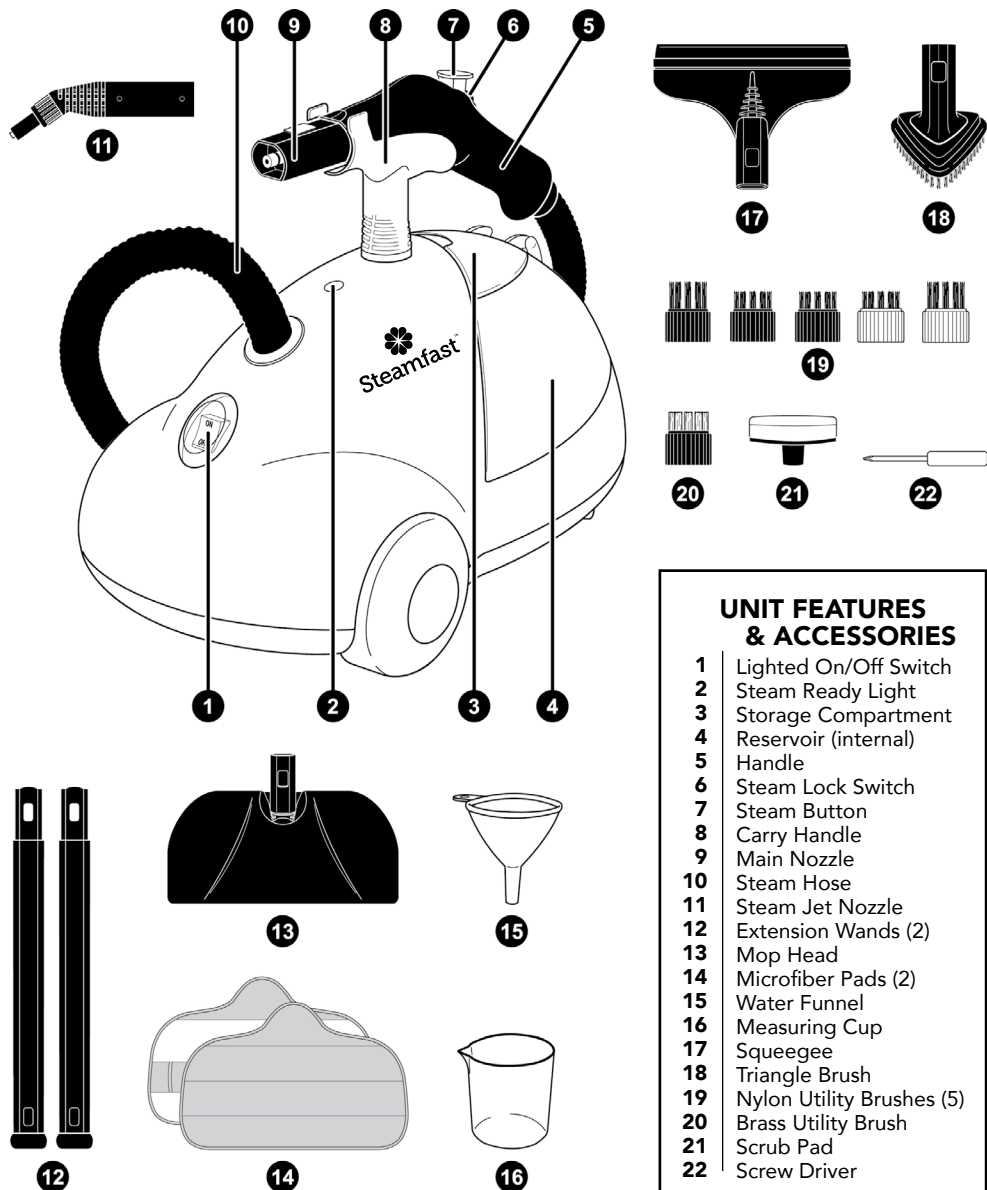

UNIT FEATURES & ACCESSORIES

- 1 | Lighted On/Off Switch
- 2 | Steam Ready Light
- 3 | Storage Compartment
- 4 | Reservoir (internal)
- 5 | Handle
- 6 | Steam Lock Switch
- 7 | Steam Button
- 8 | Carry Handle
- 9 | Main Nozzle
- 10 | Steam Hose
- 11 | Steam Jet Nozzle
- 12 | Extension Wands (2)
- 13 | Mop Head
- 14 | Microfiber Pads (2)
- 15 | Water Funnel
- 16 | Measuring Cup
- 17 | Squeegee
- 18 | Triangle Brush
- 19 | Nylon Utility Brushes (5)
- 20 | Brass Utility Brush
- 21 | Scrub Pad
- 22 | Screw Driver

- The *Lighted On/Off Switch* (1) activates and deactivates the unit, and illuminates to provide a clear visual indication of whether the unit is powered on.
- The *Steam Ready Light* (2) illuminates while the *Reservoir* is heating, then turns off when the unit is ready to begin steaming.
- The *Storage Compartment* (3) provides a convenient place to store small accessories; it also houses the *Reservoir* cap.
- The *Reservoir* (4) is the internal reservoir in which water is stored and heated. It is accessed by removing the *Reservoir* cap found inside the *Storage Compartment*. There must be a sufficient amount of water in the *Reservoir* in order for the unit to properly function.
- The *Handle* (5) is designed to stay cool while providing the optimum amount of safety and user comfort.
- The *Steam Lock Switch* (6) is pushed forward to lock the *Steam Button* down and provide continuous, hands-free steaming.
- The *Steam Button* (7) provides full steam-on-demand control, releasing hot, penetrating steam from the *Main Nozzle* when pressed.
- The *Carry Handle* (8) functions as a convenient holder for the *Main Nozzle*, and is designed for carrying the unit up stairs and over obstacles.
- The *Main Nozzle* (9) emits a powerful flow of steam when the *Steam Button* is pressed.
- The *Steam Hose* (10) safely channels the flow of steam from the *Reservoir* to the *Main Nozzle*.
- The *Steam Jet Nozzle* (11) focuses the flow of steam from the *Main Nozzle*, and serves as the base to which the *Utility Brushes* and *Scrub Pad* connect.
- The *Extension Wands* (12) connect to the *Main Nozzle*, allowing for floor mopping as well as easier cleaning in high or hard-to-reach places.
- The *Mop Head* (13) connects to the *Extension Wands*, and is designed for steam cleaning a variety of hard floor surfaces.
- The *Microfiber Pads* (14) attach to the *Mop Head*, and are designed for removing scuffs and stains from hard floors. The *Pads* are reusable and machine washable.
- The *Water Funnel* (15) and the *Measuring Cup* (16) are provided to assist in easily and consistently filling the *Reservoir* with the optimum amount of water (16 - 48 oz. / 473 - 1,420 ml.).
- The *Squeegee* (17) connects to either the *Main Nozzle* or *Extension Wands*, and can be used to clean mirrors, windows and other smooth glass surfaces.
- The *Triangle Brush* (18) connects to the *Main Nozzle* or *Extension Wands*, and is designed for cleaning corners and other difficult angles.
- The assorted *Nylon Utility Brushes* (19) connect to the *Steam Jet Nozzle*, providing extra scrubbing power for removing exceptionally tough dirt and stains.
- The *Brass Utility Brush* (20) connects to the *Steam Jet Nozzle* and is designed for removing tough stuck-on grease and grime from durable surfaces such as ovens and grills.

NOTE: Use careful judgement when deciding what surface to clean with the *Brass Utility Brush*. Some delicate surfaces, such as stainless steel, may be scratched or damaged by the brass bristles. If you are unsure whether or not a surface will be damaged, it is recommended that you test a small inconspicuous spot before proceeding.

- The *Scrub Pad* (21) connects to the *Steam Jet Nozzle* and is designed to scrub tough dirt and scuffs from surfaces.
- The *Screw Driver* (22) is included to connect the *Carry Handle* to the main unit body, using the screw found inside the *Carry Handle*.

STEAM MOPPING ACCESSORIES

WARNING: Do not try to connect accessories while unit is emitting steam.

EXTENSION WANDS

1. Select one of the Extension Wands, and align rear end of wand with Main Nozzle. Rectangular hole in wand should align with gray lock/release button on nozzle.
2. Press down on gray lock/release button. While continuing to hold button down, slide Extension Wand onto Main Nozzle (FIGURE 1-A). Push wand over button, and continue pushing until button snaps through hole on wand.
3. Slide second Extension Wand onto end of the one you just connected, this time lining up rectangular hole of second wand with gray lock/release button of first wand. Press and hold button, and firmly push second wand onto end of first wand until button snaps through hole (FIGURE 1-B). Both Extension Wands should now be connected to the Main Nozzle.

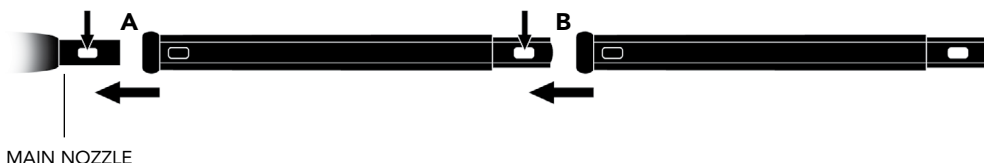

FIGURE 1

MOP HEAD

1. Align Mop Head with end of second Extension Wand, so that rectangular hole in Mop Head neck aligns with gray lock/release button on wand.
2. Press down on gray lock/release button. While continuing to hold button down, slide Mop Head neck onto Extension Wand (FIGURE 2-A). Press on firmly until button snaps through hole (FIGURE 2-B).

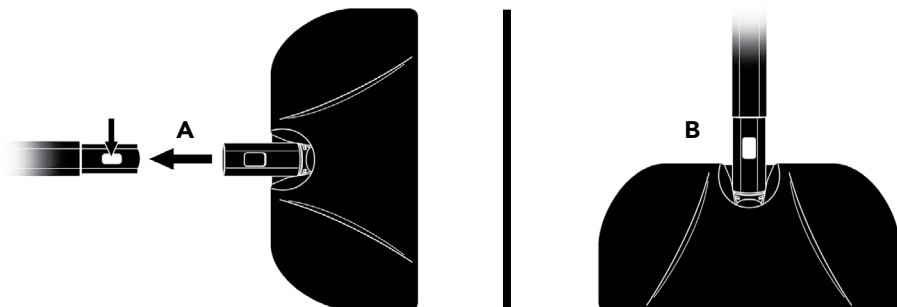

FIGURE 2

MICROFIBER PADS

1. Lay one Microfiber Pad on flat surface, with two fastener strips facing upward.
2. Align Mop Head above Microfiber Pad. Make sure Mop Head is oriented with pad as shown, and centered as best as possible (FIGURE 3-A).
3. Press Mop Head firmly down onto Microfiber Pad. Fastener strips will adhere to pad grips on underside of Mop Head. Microfiber Pad should now be attached and ready for use (FIGURE 3-B).

CAUTION: Use care when handling a recently used Microfiber Pad, as it may still be hot.

NOTE: Microfiber Pads are machine washable. To avoid picking up lint, washing separately from other fabrics is recommended. Only use liquid detergent. Avoid using any fabric softeners or bleach. Air drying is recommended; machine drying on a low heat or air dry setting is acceptable as well.

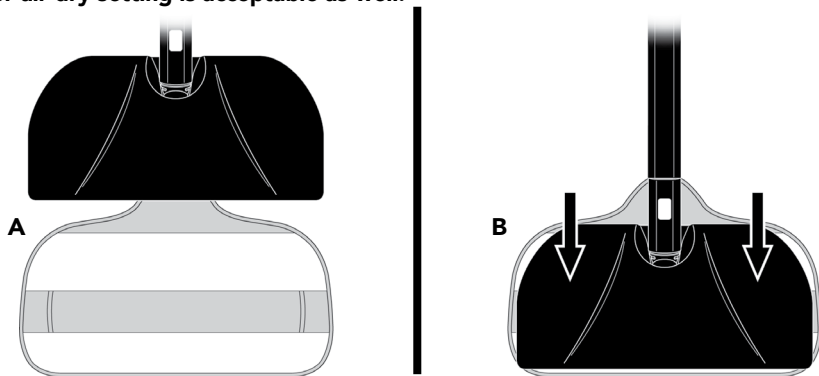

FIGURE 3

The Mop Head and Microfiber Pads are perfect for use on these hard floor surfaces:

- Sealed Hardwood
- Stained Concrete
- Sealed Laminate
- Linoleum
- Ceramic
- Granite
- Marble
- Vinyl
- Tile

IMPORTANT: Do not use on unsealed hardwood or unglazed ceramic surfaces. Surfaces that are not properly sealed may be warped or damaged by exposure to heat and moisture.

Care should also be taken when steaming sealed hardwood floors, as prolonged exposure to steam in a single spot may cause damage and discoloration. To avoid this, keep the Mop Head in constant motion on these surfaces.

Steam may remove the sheen from some floors that have been treated with wax.

Extremely rough textured floors may tear or damage Microfiber Pads.

STEAM CLEANING ACCESSORIES

WARNING: Do not try to connect accessories while unit is emitting steam.

STEAM JET NOZZLE / SQUEEGEE / TRIANGLE BRUSH

1. Select one of the three accessories (Steam Jet Nozzle, Squeegee or Triangle Brush – Steam Jet Nozzle shown as example), and align rear end of accessory with Main Nozzle. Rectangular hole in accessory should align with gray lock/release button on Main Nozzle.
2. Press down on gray lock/release button (FIGURE 4-A). While continuing to hold button down, slide accessory onto Main Nozzle (FIGURE 4-B). Push accessory over button, and continue pushing until button snaps through rectangular hole.

NOTE: The Steam Jet Nozzle, Squeegee and Triangle Brush can be connected to the end of an Extension Wand for reaching high or difficult spots. Connect the Extension Wand (or Wands), then connect your desired accessory to the Wand in the same way as you would normally connect it to the Main Nozzle.

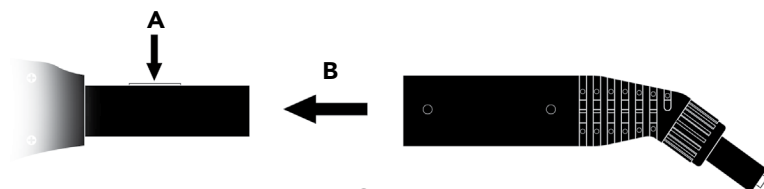

FIGURE 4

UTILITY BRUSHES

NOTE: Utility Brushes connect to the Steam Jet Nozzle, not the Main Nozzle.

1. Align guide tab on inside of Utility Brush (FIGURE 5-A) with groove on bottom of Steam Jet Nozzle tip.
2. Firmly press Utility Brush onto tip of Steam Jet Nozzle. Press it on as far as possible to prevent steam leakage.
3. To remove Utility Brush, simply grip it firmly and pull it off of Steam Jet Nozzle.



FIGURE 5

SCRUB PAD

NOTE: Scrub Pad connects to the Steam Jet Nozzle, not the Main Nozzle.

1. Place Scrub Pad over tip of Steam Jet Nozzle, and firmly press it on to Steam Jet Nozzle as far as possible (FIGURE 6). This will help to prevent steam leakage.
2. To remove Scrub Pad, simply grip it firmly and pull it off of Steam Jet Nozzle.

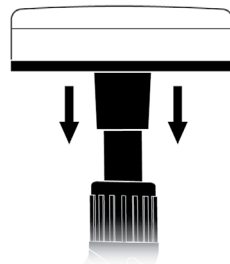

FIGURE 6

CARRY HANDLE

1. Insert Carry Handle into hole on top of unit. Align handle so that grip bracket faces towards front of unit (FIGURE 7).
2. Use enclosed Screw Driver to tighten screw found inside Carry Handle, until secured to main unit.

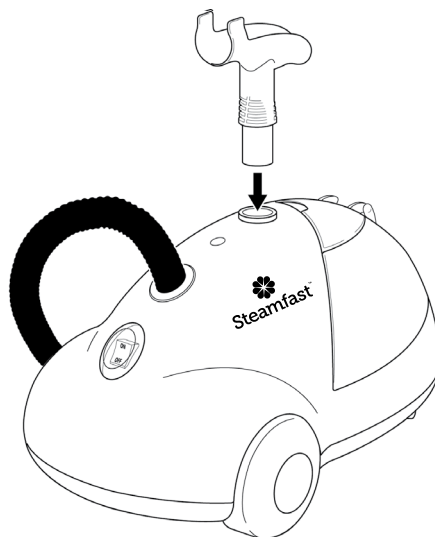

FIGURE 7

ORDERING ACCESSORIES & PARTS

Replacement accessories and parts for your Canister Steam Cleaner (model SF-275) may be ordered through our web site:

www.steamfast.com

You may also contact Consumer Service directly:

consumerservice@steamfast.com or 1-800-711-6617

FILLING RESERVOIR

1. Place Canister Steam Cleaner on a flat, level surface.
2. Make sure Lighted On/Off Switch is set to "OFF" position and grounded power cord is unplugged from electrical outlet.
3. Flip Storage Compartment lid open, and cautiously unscrew and remove Reservoir cap.
4. Drain any water remaining inside Reservoir into a sink or tub.

NOTE: Reservoir should be emptied after each use – this will help minimize mineral build-up and prevent over-filling.

5. Fill Measuring Cup to maximum fill line (16 oz. / 473 ml.) with water.

NOTE: In order to significantly reduce mineral build-up and prolong the life of your Canister Steam Cleaner, use of distilled or de-mineralized water in the unit is highly recommended.

6. Using Water Funnel, carefully pour water from Measuring Cup into Reservoir through fill hole.

CAUTION: Water Funnel should always be used to fill Reservoir, to prevent spilled water from entering unit housing and damaging electrical components.

7. Depending on how long you intend to steam, you may repeat steps 5 & 6 up to two more times, up to a maximum of 48 oz. (1,420 ml.) of water. See chart for a comparison of the amount of water vs. approximate steam time.

Amount of Water	Duration of Steam
16 oz. (473 ml.)	Approximately 15 min.
32 oz. (946 ml.)	Approximately 30 min.
48 oz. (1420 ml.)	Approximately 45 min.

8. Replace Reservoir cap, ensuring that it is screwed on tightly to prevent hot steam from escaping and causing injury.
9. Close Storage Compartment lid.

REFILLING RESERVOIR



If unit has been in use, always use the following safety precautions before removing the Reservoir cap to add water:

- Allow unit to cool for 20 minutes.
- Press and hold Steam Button to release all remaining steam. **Steam can remain pressurized inside Reservoir for up to an hour after use.**

WARNING: Failure to follow these precautions may result in burns from escaping steam when the Reservoir cap is removed.

GENERAL OPERATION

NOTE: Be sure that Reservoir has been filled and that all desired accessories are connected before following these steps.

1. For first time use, remove protective plastic cover from electrical plug. Plug power cord into a convenient electrical outlet.
2. Switch Lighted On/Off Switch to "ON" position. Steam Ready Light will immediately illuminate, indicating that unit is heating.
3. Steam Ready Light will turn off in 2-8 minutes (depending on how much water is in Reservoir), indicating that unit is fully heated and ready to begin steaming. *It is common for the Steam Ready Light to turn on and off during use. The unit itself is not turning on and off, but rather the boiler is heating at times and not at other times.*
4. Direct nozzle (and any connected accessories) towards surface you desire to steam, and press Steam Button.

CAUTION: Always be sure that nozzle and any accessories are pointed in a safe direction (away from yourself, other people, pets, and plants) before pressing Steam Button.

5. Keep Steam Button pressed for a continuous flow of steam. You may also slide the Steam Lock Switch forward while pressing the Steam Button to lock it down. This will allow a continuous flow of steam without need of holding the Button down manually.
6. Using a slight back-and-forth motion over the area you are steaming will further enhance the cleaning process. Wipe steamed areas with a clean cloth to remove loosened dirt and grime. Wiping the area while it is still wet is recommended, but use caution when wiping surfaces such as metal that may still be hot.

NOTE: During use, the Steam Ready Light may illuminate. This is normal. If you notice a drop in steam pressure, release Steam Button until Steam Ready Light turns off again.

7. Once steaming tasks are complete, immediately set Lighted On/Off Switch to "OFF" position and unplug grounded power cord from electrical outlet.

STEAM MOPPING

NOTE: Be sure that Reservoir has been filled and that all steam mopping accessories are connected before following these steps.

It is recommended to sweep or vacuum hard floors before mopping.

1. Follow STEPS 1-3 of **General Operation** section above.
2. For best results, use a steady back-and-forth motion over floor surface, pushing the Mop Head away and pulling it back towards you. Work your way backwards over the floor, in order to avoid walking over freshly mopped areas.

NOTE: To avoid warping or damage caused by heat and moisture, do not use on unsealed hardwood or unglazed ceramic surfaces. Steam may remove the sheen from some floors that have been treated with wax.

3. The Microfiber Pad will absorb dirt and moisture during mopping. However, when you are finished you may find some residual moisture has been left behind. In this case, it is recommended to allow floor time to air-dry. A fan may be directed towards mopped area to facilitate drying.

PROPER STORAGE

Preparing your Canister Steam Cleaner for storage is quick and simple. When you have finished your steaming tasks, follow the steps listed below.

1. Set Lighted On/Off Switch to "OFF" position and unplug power cord from electrical outlet.
2. Allow unit to cool (at least 30 minutes for complete cooling).
3. Press and hold Steam Button to release all remaining steam pressure.
4. Remove all accessories from unit.
5. Flip Storage Compartment lid open and remove Reservoir cap.
6. Drain any remaining water from Reservoir into a sink or tub – this will help to minimize mineral build-up and prevent over-filling during your next use. Loosely replace Reservoir cap.
7. Store accessories safely away, near Canister Steam Cleaner. Utility Brushes can be conveniently stored in the Storage Compartment.
8. Close Storage Compartment lid and store Canister Steam Cleaner in a cool, dry location.

MINERAL BUILD-UP

A common maintenance need for steam appliances is the removal of build-up caused by high mineral content in many municipal water supplies. This mineral build-up may limit the effectiveness and reduce the life of your Canister Steam Cleaner.

The best way to minimize mineral build-up is to use distilled or de-mineralized water when using your Canister Steam Cleaner. If you are unable to use distilled water, it is recommended that the following procedure be followed monthly to help remove any mineral build-up:

1. Set Lighted On/Off Switch to "OFF" position and unplug power cord from electrical outlet.
2. Allow unit to cool (at least 30 minutes for complete cooling).
3. Press and hold Steam Button to release all remaining steam pressure.
4. Remove all accessories from unit.
5. Flip up Storage Compartment lid and remove Reservoir cap.
6. Drain water from Reservoir into a sink or tub.
7. Fill Measuring Cup with 16 oz. (474 ml.) distilled vinegar.
8. Carefully pour vinegar into Reservoir. Slowly shake or move unit around to agitate vinegar.
9. Allow to stand for at least 40 minutes, or more if possible.
10. Drain vinegar from Reservoir.
11. Rinse Reservoir with fresh water, drain and repeat until vinegar odor dissipates.
12. Loosely replace Reservoir cap and close Storage Compartment lid.

PROBLEM	POSSIBLE CAUSE	SOLUTION
Unit fails to heat up. Lighted On/ Off Switch DOES NOT illuminate when set to "ON" position.	Unit is not plugged in.	Plug power cord into electrical outlet.
	Household circuit breaker / ground fault interrupter has tripped or blown a fuse.	Reset circuit breaker / ground fault interrupter, or replace fuse. If you need assistance, contact a licensed electrician.
	Unit is damaged or otherwise in need of repair.	Immediately cease usage and unplug. Contact Consumer Service for further assistance.
Unit fails to heat up. Lighted On/ Off Switch DOES illuminate when set to "ON" position.	Reservoir is empty.	Refer to Filling Reservoir procedure.
	Mineral build-up in unit.	Refer to Mineral Build-up section for cleaning procedure.
	Unit is damaged or otherwise in need of repair.	Immediately cease usage and unplug. Contact Consumer Service for further assistance.
Steam output is weak or intermittent.	Water level in Reservoir is running low.	Refer to Filling Reservoir procedure.
	Mineral build-up in unit.	Refer to Mineral Build-up section for cleaning procedure.
Excessive amount of water in steam. NOTE: Unit produces moist steam – it is normal for steam to contain some amount of water.	Water condensation in Steam Hose.	Point nozzle towards sink, tub or ground and shake while pressing Steam Button. Continue until excess water is released.
	Reservoir has been overfilled.	Filling Reservoir with more than 48 oz. (1,420 ml.) of water interferes with steam production, resulting in water condensation in steam. Drain some water out of Reservoir. Always use included Measuring Cup to fill Reservoir with correct amount of water.
	Unit has not heated to full operating temperature.	Wait until Steam Ready Light turns off to begin steaming.
Accessories do not stay firmly connected to Main Nozzle.	Accessories not properly installed.	Check to make sure that accessories are properly connected.
Floor surfaces appear cloudy or streaky after steaming.	Microfiber Pad is dirty.	Replace Microfiber Pad with a clean one.
	Hard water residue on floor.	Switch to distilled or de-mineralized water.

Steamfast, a division of Vornado Air, LLC. Steamfast warrants to the original consumer or purchaser this Steamfast ("Product") is free from defects in material or workmanship for a period of two (2) years from the date of purchase. If any such defect is discovered within the warranty period, Vornado, at its discretion, will repair or replace the Product at no cost.

For warranty service: Call 1-800-711-6617 or email consumerservice@steamfast.com to obtain a Return Authorization ("RA"). Please have or include your Product's model number and serial number, as well as your name, address, city, state, Zip code, email, and phone number when contacting Vornado for warranty service. To file a contactless warranty claim, visit www.steamfast.com/contact

After receiving the RA, ship your Product to: Vornado Air LLC Attn: Warranty & Repair 415 East 13th Street, Andover, KS 67002. For your convenience, please have your model number and serial number when contacting Vornado with service inquiries. To ensure proper handling, packages must be clearly marked with the RA number. Packages not clearly marked with the RA number may be refused at the receiving dock. Please allow 2–3 weeks for warranty service and return of your Product after the Product is received.

This warranty does not apply to defects resulting from abuse of the Product, modification, alteration, mishandling, improper maintenance, commercial use or repair or service of the Product by anyone other than Vornado; damages which occur in shipment or are attributed to acts of God. Improper product use, which includes using an external device that alters or converts the voltage or frequency of electricity, or shipping a Vornado product to a country not intended for use will void all warranties. Any unauthorized product modification, repair by unauthorized repair center or use of non-approved replacement parts is not recommended and any consequences will not be covered by support services or product warranties.

The product warranty will be honored only on models that are being used in the country intended. REPAIR OR REPLACEMENT AS PROVIDED UNDER THIS WARRANTY IS THE EXCLUSIVE REMEDY OF THE CONSUMER. VORNADO SHALL NOT BE LIABLE FOR ANY INCIDENTAL OR CONSEQUENTIAL DAMAGES FOR BREACH OF ANY EXPRESS OR IMPLIED WARRANTY ON THIS PRODUCT. EXCEPT TO THE EXTENT PROHIBITED BY APPLICABLE LAW, ANY IMPLIED WARRANTY OF MERCHANTABILITY OR FITNESS FOR A PARTICULAR PURPOSE ON THIS PRODUCT IS LIMITED IN DURATION TO THE DURATION OF THIS WARRANTY. Some states do not allow the exclusion or limitation of incidental or consequential damages, or allow limitations on how long an implied warranty lasts, so the above limitations or exclusions may not apply to you. This warranty gives you specific legal rights, and you may have other rights that vary from state to state. The manufacturer assumes no responsibility for damage or injury caused by failure to follow these instructions, improper product use or unauthorized product modifications. Any such actions will invalidate the product warranty.

All company names and product names are trademarks of their respective owners. ©All rights reserved. All technical information, data and instructions for the installation, connection and operation contained in these instructions for use correspond to the latest available information at time of printing. The contents of this manual may differ slightly from the actual product. Observe any additional supplements.

© 2023 Vornado Air, LLC. Andover, KS 67002, U.S. Specifications subject to change without notice. Steamfast® is a trademark owned by Vornado Air, LLC. Manufactured in China.

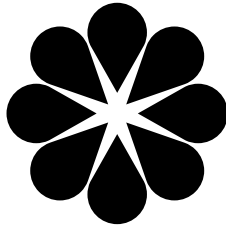

SteamfastTM

1-800-711-6617 | steamfast.com | consumerservice@steamfast.com