



steamfast

powerful. natural. intelligent.®

Everyday Steam Mop User's Guide

Guía Para El Usuario Del Trapeador A Vapor Para Uso Diario

Guide D'utilisation – Balai À Vapeur D'usage Quotidien

READ AND SAVE THESE INSTRUCTIONS

Keep your receipt for warranty purposes.

LEER Y GUARDAR ESTAS INSTRUCCIONES

Conservar el recibo para la garantía.

LISEZ ET CONSERVEZ CES INSTRUCTIONS

Gardez votre reçu aux fins de la garantie.

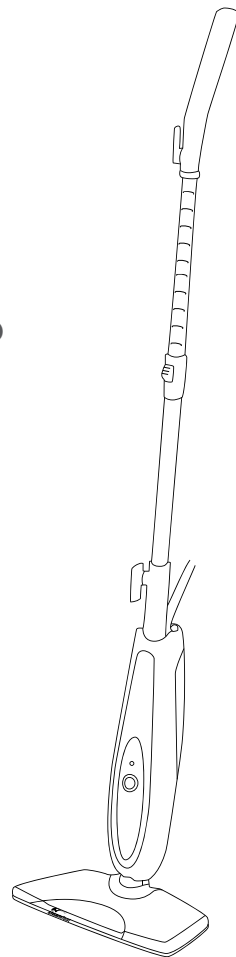

model SF-150



Questions or comments?

¿Preguntas o comentarios?

Questions ou commentaires?

 www.steamfast.com

 consumerservice@steamfast.com

 1-800-711-6617

Important Instructions	4	Troubleshooting	15
Product Information	6	Warranty	16
Initial Setup			
Telescopic Pole.....	8		
Microfiber Pads.....	9		
Mopping Recommendations.....	10		
How To Use			
Filling the Water Tank.....	11		
Operation.....	12		
Removing Mineral Build-Up.....	13		
Storage and Care			
Storage.....	14		
Washing Microfiber Pads.....	14		
Automatic Refill Program.....	14		

IMPORTANT INSTRUCTIONS

 **WARNING:** To reduce risk of fire, electrical shock or injury, the following basic safety precautions should always be followed when using an electrical appliance.

 **WARNING:** This appliance has a polarized plug (one blade is wider than the other). To reduce the risk of electric shock, this plug is intended to fit in a polarized outlet only one way. If the plug does not fit fully in the outlet, reverse the plug. If it still does not fit, contact a qualified electrician. Do not modify the plug in any way.

DANGER

Any appliance is electrically live even when switched off. To reduce risk of electrical shock:

1. Always unplug power cord immediately after using.
2. Do not place or store unit where it can fall or be pulled into a sink or tub.
3. Do not place, immerse or drop into water or other liquid.
4. If unit falls into water, immediately unplug power cord. Do not reach into the water.

WARNING

To reduce risk of burns, electrocution, fire, or injury to persons:

1. Use Everyday Steam Mop only for its intended purpose as indicated in this manual.
2. If an extension cord is necessary, use a properly rated cord (15 ampere, 14 gauge). Use care to position extension cord where it is least likely to be damaged or tripped over during use.
3. Before plugging power cord into electrical outlet, be sure that all electrical information on rating label agrees with your power supply.
4. To reduce likelihood of circuit overload, DO NOT operate another high wattage appliance on the same circuit as this unit.
5. To protect against risk of electrical shock, do not immerse unit in water or

other liquids. Do not use power cord as handle, let it hang over edges of counters, or be crimped or closed in doors.

6. Never yank power cord to disconnect from outlet; instead, grasp plug and pull to disconnect.
7. Do not operate unit with a damaged power cord or if the unit has been dropped or damaged. To avoid risk of electrical shock, do not disassemble unit; contact Steamfast Consumer Service. Incorrect reassembly can cause a risk of electrical shock when unit is used.
8. Close supervision is required for any appliance being used near children, pets and plants. Do not leave unit unattended while plugged in.
9. This unit is not intended for use by persons (including children) with reduced physical, sensory or mental capabilities, or lack of experience and knowledge, unless they have been given supervision or instruction concerning use of the unit by a person responsible for their safety.
10. Do not use unit where aerosol-based products are being used, or where oxygen is being administered.
11. Unit is only meant to be used with recommended Everyday Steam Mop model SF-150 accessories. Using other types of accessories may cause damage to unit or injury.
12. If Power Indicator Light does not illuminate when unit is plugged in and the Power Button is pressed, unit is not operating normally. Immediately disconnect cord from power supply, then contact consumer service for assistance.
13. Do not attempt to use unit without properly filling the Water Tank.
14. When filling Water Tank, only water should be used in unit – other cleaning agents could damage unit or cause injury. Distilled or de-mineralized water is highly recommended, in order to minimize potential build-up of mineral deposits. Do not overflow unit.
15. To reduce risk of contact with hot water emitting from Mop Head, check appliance before each use by positioning it away from body and turning it on. Do not operate unit if steam outlets are blocked.

IMPORTANT INSTRUCTIONS

16. Burns can occur from touching hot plastic parts, hot water, or steam. Do not touch Mop Head or attempt to apply any accessories while unit is in use.
17. Use Caution when using unit on uneven surfaces, such as stairs.
18. When steaming a surface for the first time, it is recommended that you consult the manufacturer's guidelines for the floor being steamed. For items in question, test on an inconspicuous area before proceeding.
19. Steaming unsealed hardwood or unglazed ceramic surfaces is not recommended, and may result in warping or damage to the surface. Steam may remove the sheen from surfaces treated with wax.
20. When steam mopping, never leave unit resting in one spot on any surface for any period of time - prolonged exposure to heat and moisture may damage floor surfaces.
21. Do Not use for space heating purposes.
22. Empty the Water Tank when not in use.
23. Do not allow power cord to touch hot surfaces during use. Loosely bundle cord when storing.

SAVE THESE INSTRUCTIONS FOR HOUSEHOLD USE ONLY

Questions or comments?

- www.steamfast.com
- consumerservice@steamfast.com
- 1-800-711-6617

Speak your mind! We invite you to review this product online:
www.steamfast.com/reviews

Product Information

The following features and accessories are included with your Everyday Steam Mop. Carefully inspect the packing material for all parts listed below.

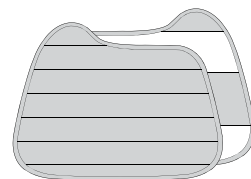
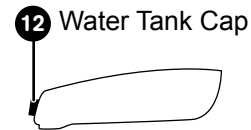
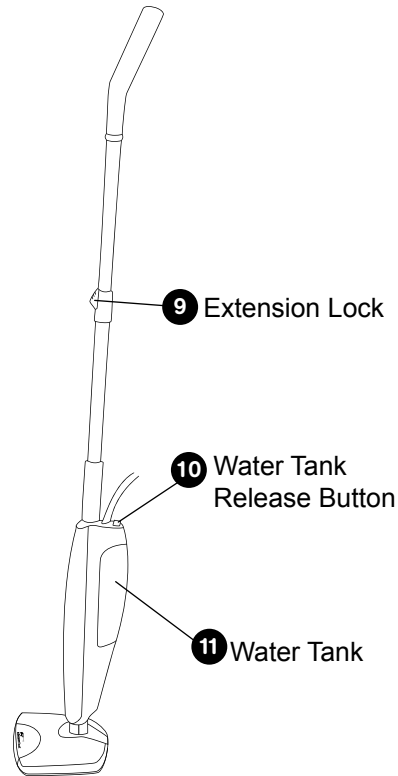
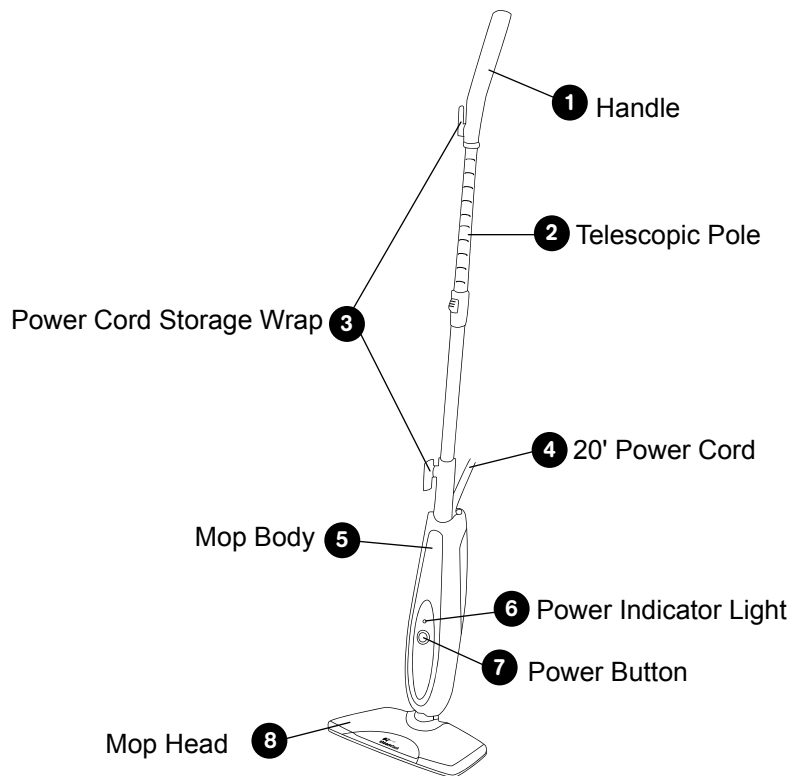

13 Microfiber Pads

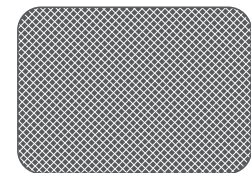

Product Information

1. The Handle connects to the top of the metal Telescopic Pole, and is designed for maximum grip and comfort.
2. The Telescopic Pole connects to the Body and Handle. Can be extended or retracted to adjust to the ideal height for use or retracted completely for more compact storage.
3. The Power Cord Storage Wrap provides a convenient way to neatly wrap the power cord for storage.
4. The 20 ft. Power Cord provides long reach.
5. The Mop Body is the main unit of the Everyday Steam Mop.
6. The Power Indicator Light illuminates to indicate that unit is receiving power. Whenever the Power Button is pressed On, the Power Indicator Light will illuminate red. The Power Indicator Light will not illuminate when the Power Button is pressed Off.
7. The Power Button, located on the front of the Everyday Steam Mop, activates and deactivates the unit. The Power Button is pressed to turn the unit On, and pressed again to turn the unit Off.
8. The Mop Head releases steam.
9. The Extension Lock is used to adjust the Telescopic Pole height.
10. The Water Tank Release Button releases the Water Tank from the Mop Body.
11. The Water Tank is the reservoir where water is held. For optimal steam production, the Water Tank should be filled with no more than 12 oz. (354 ml.) of water.
12. The Water Tank Cap attaches to the Water Tank.
13. The Microfiber Pads attach to the bottom of the Mop Head and are designed to clean scuffs and stains from hard floors. The Microfiber Pads are reusable and machine washable. (Two included.)
14. The Resting Pad serves as a base for the unit, providing a convenient place for it to rest without risk of damage to delicate floor surfaces. The Resting Pad has a smooth side and a textured side – the textured side is designed to capture excess moisture and should face upward, so that Mop Head rests on top of it.

Initial Setup

TELESCOPIC POLE

1. Connect Handle to upper, narrower end of Telescopic Pole. To do this, simply slide Handle onto Telescopic Pole until Release Button, located on Telescopic Pole, snaps through small hole on Handle (Figure 1).

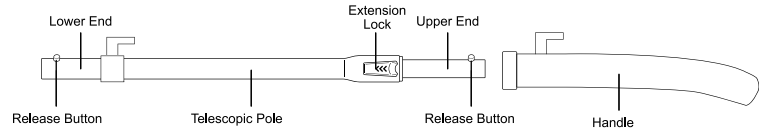

2. Insert lower, wider end of Telescopic Pole into Mop Body. (Figure 2). Make sure Release Button, aligns with the small hole on Mop Body. Press Telescopic Pole until Release Button snaps through small hole on Mop Body. Telescopic Pole should now be secured to Mop Body.

NOTE: In order to coax Release Button through hole, it may be necessary to rotate and adjust Telescopic Pole until button aligns properly with hole.

3. To adjust the height of Telescopic Pole, press and hold Extension Lock downward (Figure 3). While holding Extension Lock down, move Telescopic Pole until it is adjusted to the desired height. Release Extension Lock, then move Telescopic Pole again until it “clicks” securely into place (Figure 4).

4. To disconnect Telescopic Pole for storage, press firmly on Release Button while simultaneously pulling Telescopic Pole away from Mop Body.

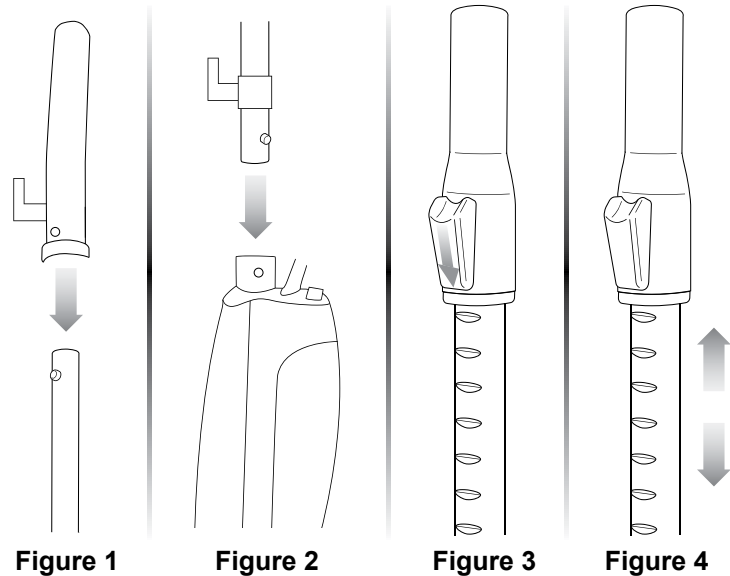

Initial Setup

MICROFIBER PADS

1. Lay one Microfiber Pad on a flat surface, with white fastener strips facing upward.
2. Align Mop Head above Microfiber Pad. Make sure Mop is oriented with Pad as shown (Figure 1).
3. Press Mop Head firmly down onto Microfiber Pad. Fastener strips will adhere to Pad Grips on underside of Mop Head. The Microfiber Pad is now attached and ready for use.
4. To remove, use your foot to press down on Microfiber Pad Release Tab (Figure 2) while simultaneously pulling the unit up and away from Microfiber Pad (Figure 3).

WARNING: Use care when handling a recently used Microfiber Pad, as it may still be hot.

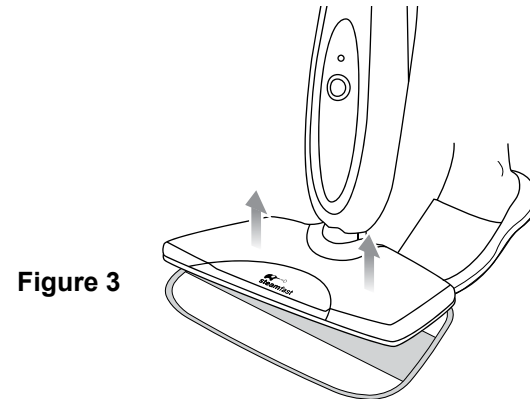
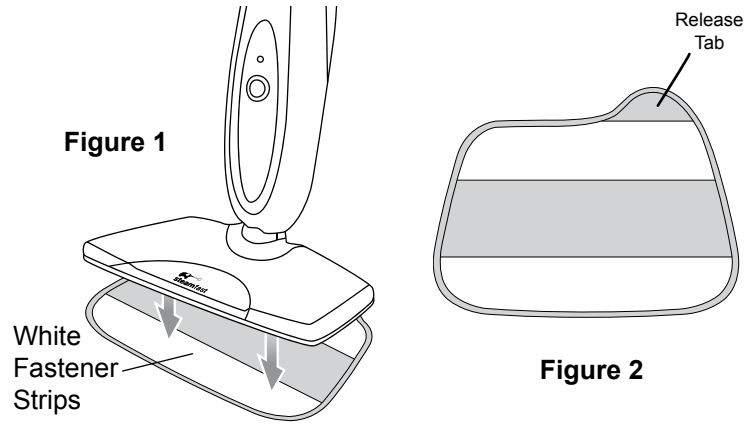

Mopping Recommendations

Accessory	Floor Type
Microfiber Pad (Super absorbent pads for every day use)	- Stone - Slate - Glazed Ceramic Tile - Vinyl - Laminate - Marble - Sealed Hardwood - Bamboo

- **WARNING:** Do not use on unsealed hardwood or unglazed ceramic surfaces. Surfaces that are not properly sealed may be warped or damaged by exposure to heat and moisture.
- Care should also be taken when steaming sealed hardwood floors, as prolonged exposure to steam in a single spot may cause damage and discoloration. To avoid this, keep the Everyday Steam Mop in constant motion on these surfaces, and place it back on Resting Pad when idle.
- Steam may remove the sheen from some floors that have been treated with wax.
- Extremely rough textured floors may tear or damage Microfiber Pads.
- **Before steaming any flooring, it is recommended to consult the manufacturer's guidelines. For flooring in question, always test on a small inconspicuous area before proceeding.**

FILLING THE WATER TANK

1. Press Water Tank Release Button to remove Water Tank. Pull Water Tank towards you and upwards to remove. (Figure 1).

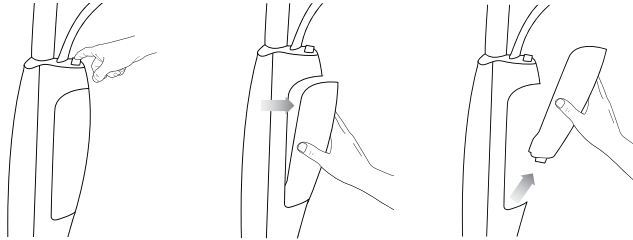

Figure 1

2. Remove Water Tank Cap by unscrewing it in a counter-clockwise direction (Figure 2). Fill Water Tank with room temperature water, up to 12oz. (354ml) (Figure 3), and replace Water Tank Cap.

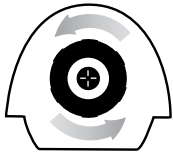

Figure 2

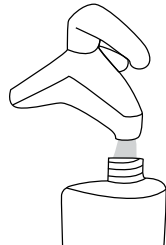

Figure 3

NOTE: To minimize potential mineral build-up, it is recommended to use distilled or de-mineralized water. If mineral build-up does form on Mop Head, refer to REMOVING MINERAL BUILD-UP to clean the unit.

3. Replace Water Tank by inserting Water Tank Cap inside the cavity of Mop Body, then push Water Tank forward until locked into place (Figure 4).

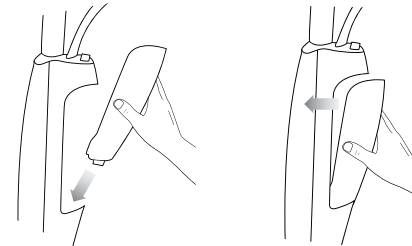

Figure 4

The Everyday Steam Mop is now ready for use. Refer to OPERATION on how to use.

How to Use

OPERATION

Before operating, make sure Microfiber Pad is properly attached and Water Tank is filled with water.

NOTE: Refer to MOPPING RECOMMENDATIONS for tips on recommended floor surfaces.

1. Unwrap Power Cord completely and plug into a 120V grounded outlet.
2. Turn On by pressing Power Button located on the front of Mop Body (A). The Power Indicator Light will illuminate red when power is On (B).
3. Place Resting Pad on floor, so that the textured side faces upward. Rest Mop Head on top of Resting Pad, in order to help protect the floor surface from excess heat and moisture (Figure 1).

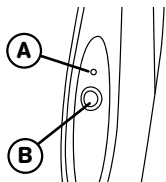
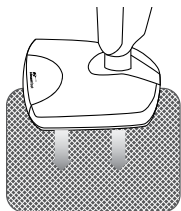

Figure 1



NOTE: Place the Everyday Steam Mop on the Resting Pad

while waiting for steam to start or when not in use.

After approximately 30 seconds of heat up time, the unit will begin emitting steam. The unit is now ready for use. It is common to hear the water pump make a noise while it is producing steam.

4. For best results, mop using a steady back-and-forth motion over the floor, working your way backwards in order to avoid walking over the freshly mopped area (Figure 2).

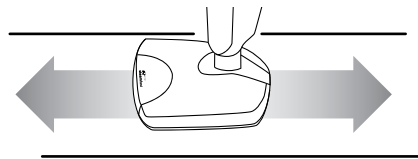

Figure 2

5. To use **Auto Steam Shut-Off** feature, simply place the mop in upright position. Continue mopping to resume steaming.
6. Once all water has been used, turn off the unit. If you wish to continue mopping, place unit on Resting Pad and refill Water Tank (refer to FILLING THE WATER TANK for instructions).
7. When finished mopping, place unit on Resting Pad and turn unit Off by pressing Power Button. Unplug Power Cord from outlet, then refer to STORAGE AND CARE.

Removing Mineral Build-Up

A common maintenance need for steam appliances is the removal of build-up caused by high mineral content in many municipal water supplies. This mineral build-up may limit the effectiveness and reduce the life of your Everyday Steam Mop.

The best way to minimize mineral build-up is to use distilled or de-mineralized water. It is recommended to clean the unit at least once a month in order to remove any deposits that form. This will help to extend the life of your Everyday Steam Mop and maximum performance.

To remove mineral build-up:

1. Press Power Button to Off (the red Power Indicator Light will turn off).
2. Remove Microfiber Pad from Mop Head.
3. Place Resting Pad on top of an absorbent cloth, then place Mop Head on top of Resting Pad to absorb the emitted steam during the cleaning process. Be sure the surface can withstand high temperatures as Resting Pad will be hot.

NOTE: The cleaning process creates an unpleasant vinegar odor. You may prefer to clean your Everyday Steam Mop in the garage or in a location with good ventilation.

4. Remove Water Tank and Water Tank Cap. Drain any water remaining in Water Tank into a sink or tub.
5. Pour 10 oz. (295 ml.) of distilled vinegar into Water Tank and reinstall Water Tank Cap.
6. Press Power Button to turn unit On.
7. Allow vinegar solution to completely run through the unit while resting on Resting Pad.

NOTE: This will take approximately 25 minutes before the Water Tank is empty.

8. Refill Water Tank with fresh distilled water, and repeat process until vinegar odor dissipates.
9. Once Mop Head has cooled, use a damp cloth to wipe off any remaining white residue on the unit.

The Everyday Steam Mop is now clean and ready for use or storage.

Storage and Care

STORAGE

1. Turn Power Button Off. Unplug Power Cord and wind on Power Cord Storage Wrap.
2. Remove and empty Water Tank. Re-install Water Tank.
3. Clean all surfaces with a clean, dry cloth and allow to dry.
4. Carefully remove Microfiber Pad from Mop Head.

WARNING: Microfiber Pad may be hot.

5. Store Everyday Steam Mop in a cool, dry location.

WASHING MICROFIBER PADS

- Microfiber Pads can be machine washed in warm water on delicate cycle. Use only liquid detergents. Do not use bleach or fabric softeners. Do not wash with other items especially cotton or cotton blended materials.
- Air drying is recommended, but they can be dried in the dryer on the low heat setting. Do not dry with other items especially cotton or cotton blended materials.

Automatic Refill Program

A convenient way to receive regular shipments of SteamFast Accessories, direct to your door. Cancel at anytime.

To sign up visit www.steamfast.com

Call: 1-800-711-6617

NOTE: Due to continuing improvements, part numbers listed may change. For assistance ordering parts, please contact Consumer Service.

MICROFIBER PADS (2)

A147-100

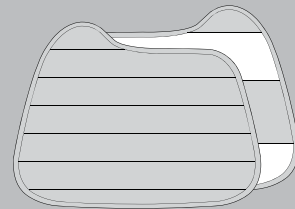

RESTING PAD

A140-003

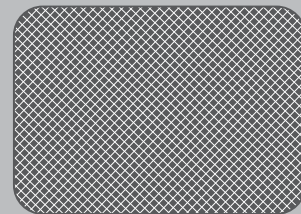

Troubleshooting

Problem	Possible Cause and Solution
Mop is not operating	- Unit is not plugged in. Plug Power Cord into electrical outlet. Make sure Power Button is in the On position and Power Indicator Light is illuminated.
	- Household circuit breaker / ground fault interrupter has tripped or blown a fuse. Reset circuit breaker / ground fault interrupter, or replace fuse. For assistance, contact a licensed electrician.
	- Unit is damaged or in need of repair. Cease usage and unplug. Contact Consumer Service for assistance.
Mop does not emit steam during use or steam output is weak	- Water Tank is empty. Fill Water Tank with distilled water.
	- Mineral deposits have built up in mop. The unit needs to be cleaned. Refer to REMOVING MINERAL BUILD-UP for cleaning instructions.
After mopping, streaks or dirt remain on floor	- Microfiber Pad is dirty - wash current Microfiber Pad and attach a new or freshly laundered pad to Mop Head. Re-steam the areas where streaking or dirt remains.
Mop does not emit steam in upright position.	- In upright position, the unit is in the Auto Steam Shut-Off mode. To begin steaming, lower handle and begin mopping.

steamfast • 1 Year Limited Warranty

Steamfast, a division of Vornado Air LLC, (“Steamfast”) warrants to the original consumer or purchaser this Everyday Steam Mop SF-150 (“Product”) is free from defects in material or workmanship for a period of one (1) year from the date of purchase. If any such defect is discovered within the warranty period, Vornado, at its discretion, will replace the Product at no cost if the Product is returned to Steamfast postage-paid.

This warranty does not apply to defects resulting from abuse of the Product, modification, alteration, repair or service of the Product by anyone other than Steamfast, mishandling, improper maintenance, commercial use of the Product, damages which occur in shipment or are attributed to acts of God.

REPLACEMENT AS PROVIDED UNDER THIS WARRANTY IS THE EXCLUSIVE REMEDY OF THE CONSUMER. STEAMFAST SHALL NOT BE LIABLE FOR ANY INCIDENTAL OR CONSEQUENTIAL DAMAGES FOR BREACH OF ANY EXPRESS OR IMPLIED WARRANTY ON THIS PRODUCT. EXCEPT TO THE EXTENT PROHIBITED BY APPLICABLE LAW, ANY IMPLIED WARRANTY OF MERCHANTABILITY OR FITNESS FOR A PARTICULAR PURPOSE ON THIS PRODUCT IS LIMITED IN DURATION TO THE DURATION OF THIS WARRANTY.

Some states do not allow the exclusion or limitation of incidental or consequential damages, or allow limitations on how long an implied warranty lasts, so the above limitations or exclusions may not apply to you. This warranty gives you specific legal rights, and you may have other rights that vary from state to state.

For warranty or repair service, call 1-800-711-6617 or email consumerservice@steamfast.com to obtain a Return Authorization (“RA”) form. Please have or include your Product’s model number, date code and serial number, as well as your name, address, city, state, zip code and phone number when contacting Steamfast for warranty service. You may be required to provide

the original sales receipt. For your records: Staple or attach your original sales receipt to this Owner’s Guide. Please also write your Product’s serial number below (located on product specs decal).

Serial No. _____

After receiving the RA form, ship your Product to:

Steamfast
Attn: Warranty & Repair
415 East 13th
Andover, KS 67002

To assure proper handling, packages must be clearly marked with the RA number. Packages not clearly marked with the RA number may be refused at the receiving dock.

Please allow 1-2 weeks for return of your Product after the Product is received.

Product registration available online at www.steamfast.com

© 2014 Vornado Air LLC • Andover, KS 67002
Specifications subject to change without notice.
Steamfast® is a trademark owned by Vornado Air LLC.
Manufactured in China.

Steamfast Consumer Service
W: www.steamfast.com | P: 1-800-711-6617
E: consumerservice@steamfast.com

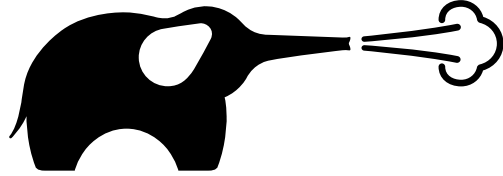

steamfast

powerful. natural. intelligent.®

review this product online
evalúe este producto en línea
évaluez ce produit en ligne
www.steamfast.com/reviews

Steamfast
415 East 13th, Andover, KS 67002
1-800-711-6617 | www.steamfast.com | consumerservice@steamfast.com